



STURGES
LONDON

Merchant Square, Paddington

£4,766 Per calendar month



- 3 Bedroom, 2 Bathroom Lateral Apartment
- Wonderful Open Kitchen/Reception Room
- Concierge service/On-site building manager
- Underground Parking available (by request)
- Great Onsite Security
- Great Location in Vibrant Paddington Basin
- Incredible Transport Links into Central London & the West End
- Plenty of storage space





, London

This stunning interior designed luxury apartment has three spacious and light bedrooms situated on the first floor of this prestigious building which features a concierge service, lift service and secure underground parking.

This modern apartment comprises of Reception room, an open plan kitchen, three bedrooms, two bathrooms and ample storage space.

The apartment offers easy access to superb transport links such as Paddington Train Station (Elizabeth line, Bakerloo, Hammersmith & City, Circle, District lines and Heathrow Express) and Edgware Road (Circle, District and Bakerloo lines).

Local Authority:

Council Tax Band: E

Lease: Add text here

Service Charges: Add text here

Ground Rent: Add text here

STURGES
LONDON

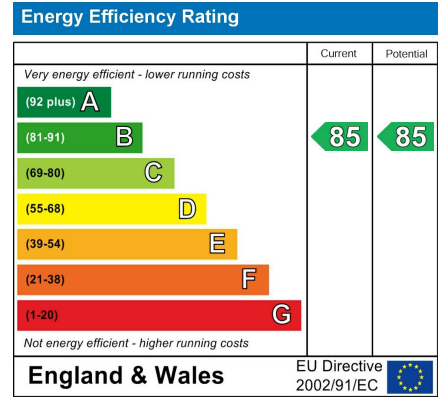
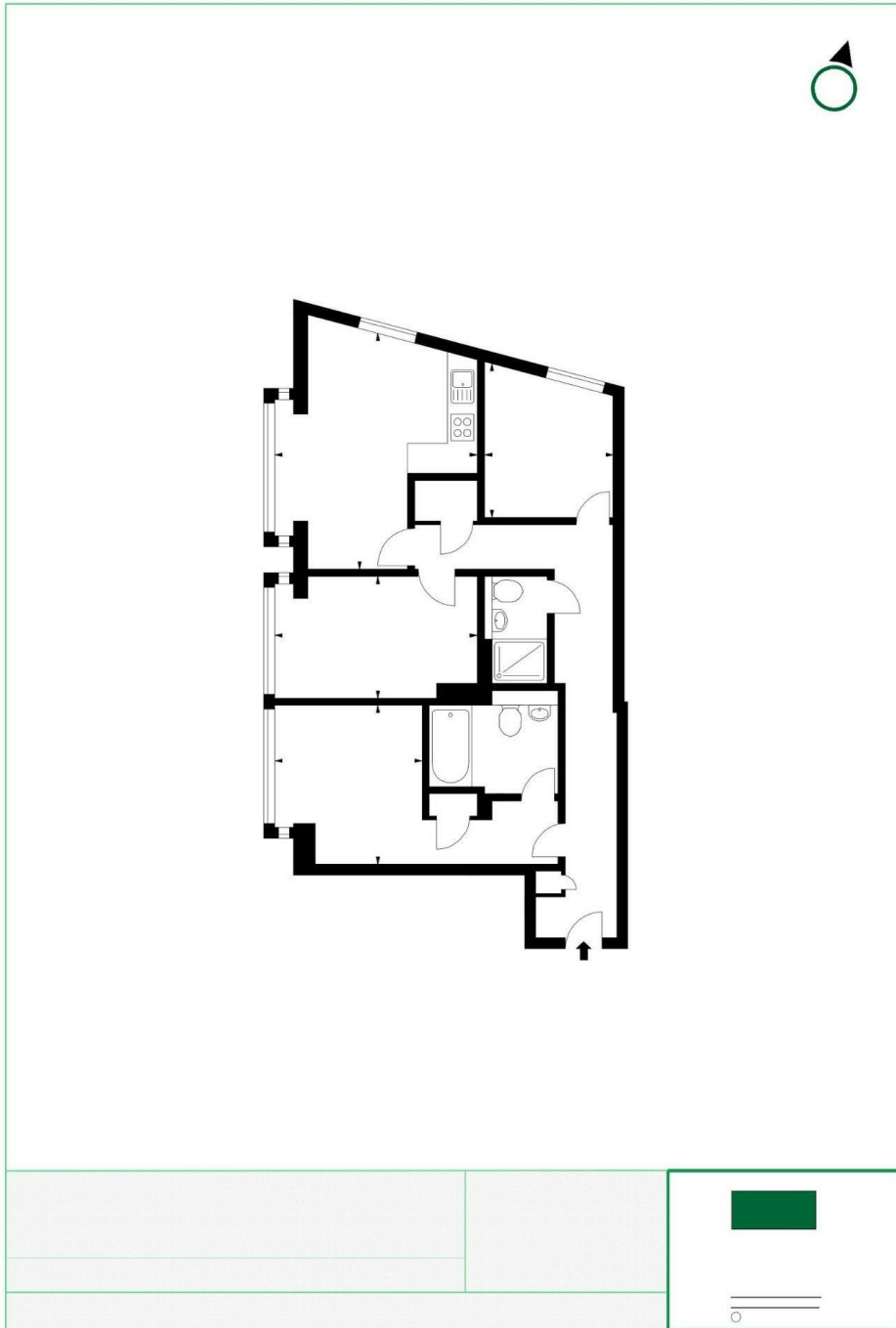

For more information, please contact:

(Tel) 020 3393 2002
 (Email) hello@sturgeslondon.co.uk

668 Fulham Road, Parsons Green, London, SW6 5RX

sturgeslondon.co.uk

Agents Note: Whilst every care has been taken to prepare these particulars, they are for guidance purposes only. All measurements are approximate and for general guidance purposes only and whilst every care has been taken to ensure accuracy, they should not be relied upon and potential buyers/tenants are advised to recheck the measurements.